

Oceanis 51.1

2019





NOMINATIONS

Beneteau Oceanis 51.1, competing with five nominated ships, on the part of the judicial board of the renowned Italian nautical magazine "Vela e motore", had been CHOSEN FOR SHIP OF THE YEAR 2017 in its category.

It was also nominated at the forthcoming Dusseldorf Boat Show as well at the British Yachting Awards 2018.



LUXURY SPORTSMAN

Oceanis 51.1 has already caused great interest in nautical circles with its look, technical hull innovations and impressive sailing characteristics, so we have selected a premium configuration that will provide you with a combination of simple top sailing and cruising with the accentuated comfort during your stay on board.

In short, the best from the best!



SAILS

The Roll Genoa and the main sail provide the possibility of simple sailing management in all weather conditions. Four windlasses with which the sails are managed from the cockpit, are positioned in the ideal positions and leave space in the spacious cockpit for a pleasant stay of crew and guests during the sailing.

DRAFT

The extraordinary depth of a specially designed keel of only 1.92 m, (standard depth is 2.36 m) allows access to all bays where you want to spend day or night, and anchor securely. Among other things, a carefully selected keel also allows access to a number of smaller ports and fuel stations across the Adriatic coast as some are found in shallow waters.





COCKPIT

Staying in a spacious cockpit is additionally improved with an adjustable sprayhood and bimini that cover its entire surface and easily adapt the cockpit to a sun deck or a sunshade. Two long loungers, are an innovative solution that differentiates the Oceanis 51.1 cockpit from other boats. They will help you achieve your desired tan or relaxing in the shade with a refreshing drink. All the seats in the cockpit are covered with comfortable cushions.

The spacious, retractable cockpit table is ideal for cheerful gatherings, gourmet delicacies or romantic evenings accompanied by an indirect LED lighting located on the floor of the cockpit. Swimming is a special pleasure along the stern platform that is lifted or lowered automatically by an electric motor, thus becoming a sun deck or quality extra space. The entire cockpit and the automatic platform are covered with teak.

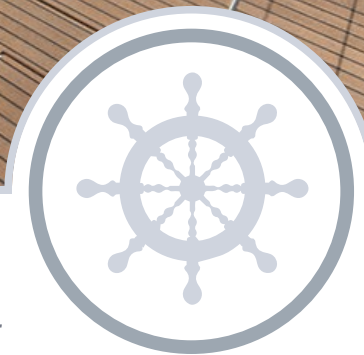

EQUIPMENT IN THE COCKPIT

Two steering helms are surrounded by navigational instruments so you have an autopilot, a multifunctional touchscreen plotter with sea charts and all the other information needed for safe navigation, an anchor winch control with an anchor chain length counter that makes it easy to safely anchor the ship, as well as the bow thruster control knob.



ENGINE

Yanmar's outstanding diesel power engine with a power of 110 hp is also the most powerful engine that is fitted on the Oceanis 51.1 by the manufacturer, with additional tanks with an increased fuel volume of 400 l, it will safely and quickly bring you to every one of your destinations and provide you with a great navigational autonomy.

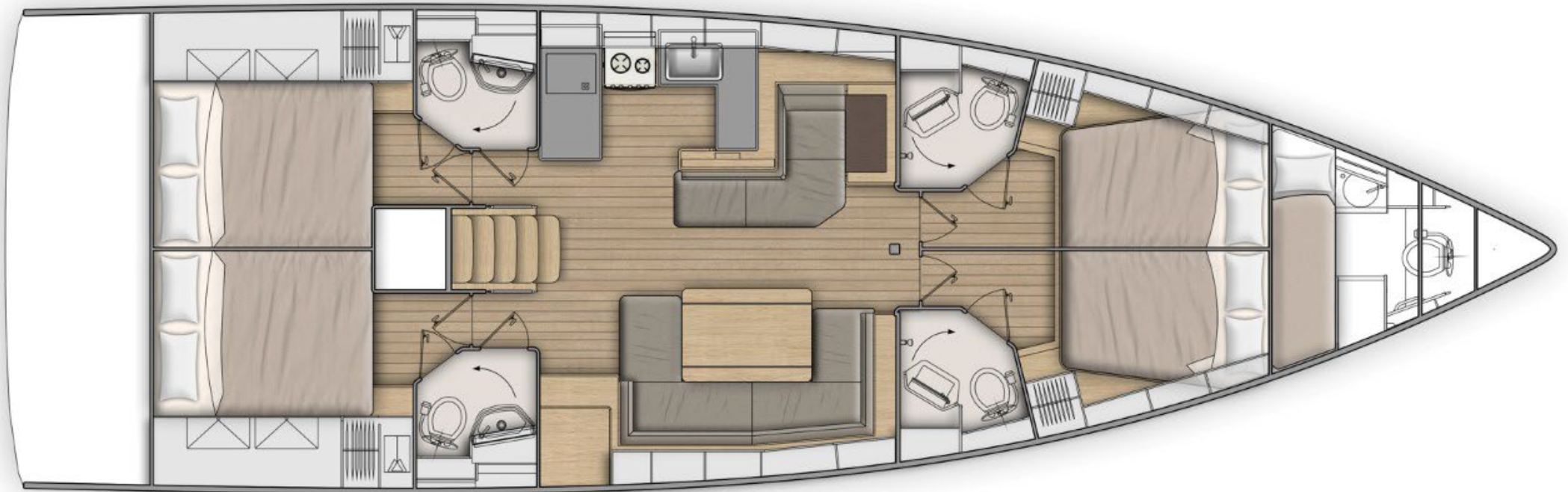

LAYOUT

Guest and crew accommodation is available in four luxury cabins, each with its own bathroom and toilet (each toilet is equipped with an electric pump and a blackwater tank) that gives you complete intimacy, as well as a separate skippers bow cabin with a separate entrance and a toilet.



AIR-CONDITIONED INTERIOR

The spacious salon and kitchen will allow you to stay in the air-conditioned area as there are 2 air conditioners for cooling and heating. One for the salon and stern cabins and the other for bow cabins and skipper cabins.

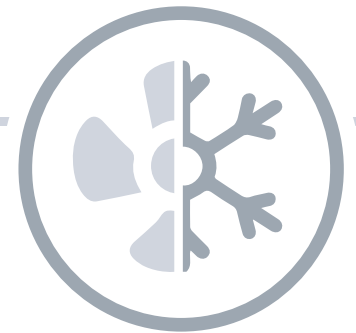



SALON AND CABINS

Hanging out or relaxing with a favorite movie or TV program is provided by Smart TVs, one in the salon and two in the cabins, where children can have fun with their favorite games or the internet that is available through a router on the boat. The Fusion Audio system in the salon and the cockpit are available to have fun or relax with the music you can play from your favorite devices (USB, bluetooth connection to Fusion Audio).



KITCHEN

The kitchen equipped with a stove, a classic and microwave oven makes it possible to prepare even the most demanding culinary recipes, while the freshness of food and a pleasant beverage temperature are guaranteed by two refrigerators in the salon and a chill box inside the cockpit table. 770 l of fresh water is available.



ADDITIONAL BATTERIES

Unlike the standard model with two consumer and one starting battery we have prepared you a boat with 5 consumer batteries of 140Ah each. We replaced standard lead batteries with quality AGM batteries.

The 700Ah power will provide you with a high quality power supply for all devices and consumers.

The starting battery has a capacity of 120Ah.



GENERATOR

When you are not in a marina or harbor, connected to the power grid, the generator will allow you to use all the necessary electrical appliances (TV, AC, fridge, etc.). USB 5 V sockets are available in each cabin. The boat is also equipped with an inverter 12 / 220V so that guests can use all their devices at any time.



GENERAL SPECIFICATIONS

- L.O.A (with bowsprit)	15,94 m
- L.O.A (standard)	15,43 m
- Hull length	14,98 m
- Beam	4,80 m
- Shallow draft (Cast iron)	1,92 m
- Shallow ballast weight	3 604 kg
- Mast 2 spreaders	21,40 m
- Light displacement	13 930 kg
- Fuel capacity	400 L
- Fresh water capacity	770 L
- Engine power	110 HP

STANDARD SAILS DIMENSIONS

- Furling mainsail (standard)	45 m ²
- Genoa - 105 %	65 m ²

COCKPIT INSTRUMENTS

Starboard steering console:

- 1 Multifunction touchscreen Zeus 7" wide wireless (GPS, Chart plotter, Chart reader - Navionics Silver cartography included)
- Port and starboard helm stations: 1 Triton 2 display
- Wind Sensor (Windvane, Anemometer)
- Sensor (Log, Speedometer, Temperature)
- NAC3 autopilot + Control at steering station

COMFORT

- Bowtruster
- Generator
- 2 x Airconditioner (cooling and heating)

Oceanis 51.1 with its appearance, maritime performance, features and comfort is created for guests who do not accept compromises, but want the best!

The ship's delivery is in April 2019, so we use photos taken by the Beneteau to see the gray hull color, the cockpit and boat equipment selected in the configuration.